

TRANSFER TAPE INSTRUCTION

Features

- * 0.5" Grid Lines Make Transfer Paper Easy To Measure
- * Designed To Align And Transfer Vinyl
- * Easy Transfer To Most Smooth Surface
- * Medium Tack
- * Wide Application
- * Custom Cut For Small & Large Projects

Applications

Great for ADHESIVE VINYL.

It does not work for **HEAT TRANSFER VINYL, GLITTER VINYL, HOLOGRAPHIC VINYL, and PRINTABLE VINYL.**

Not Suitable for Transferring to Paper and Fabric.

Warm Tips

- * Do not apply to hot, wet, or cold surfaces.
- * Clean the surface of your project before applying the decal.
- * For large decals, please press one section at a time.
- * Best on clean, smooth, and nonporous surfaces.
- * Try the glossy vinyl cut setting on most machines.
- * Credit or gift cards can be used as a squeegee.
- * Perform a test cut and a test application.

STEPS FOR USAGE

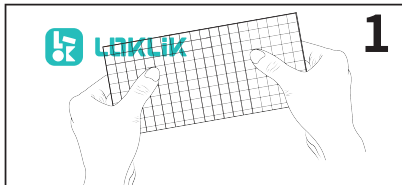

Load vinyl into the machine with the color side up. Pre-cut the vinyl and weed away the excess parts. Cut a piece of Transfer Tape in the size of your design. Cut Design with Proper Setting.

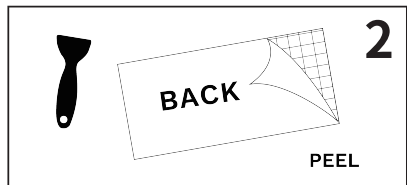

Apply transfer tape to the front of your design. Use a squeegee to secure the tape to the vinyl. Peel the release liner from the back of the vinyl, exposing the adhesive.

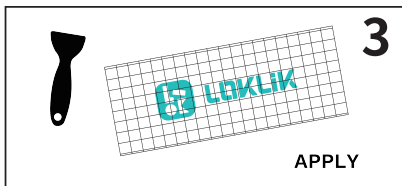

Now you can apply your design to your project. Gently place the transfer tape over the target surface. Use a squeegee and pressure to secure your design. Start in the center and move outward.

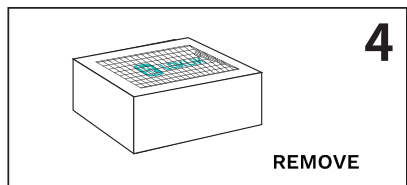

Remove the transfer tape. If the design doesn't separate from the transfer tape, apply more pressure and peel the tape off, starting from the corner.

Customer Service

Feel free to contact us if you have any questions or concerns.

Web: www.loklik.com